

# Optional function parts

- 39
- 40
- 41
- 42
- 43
- 98
- 99

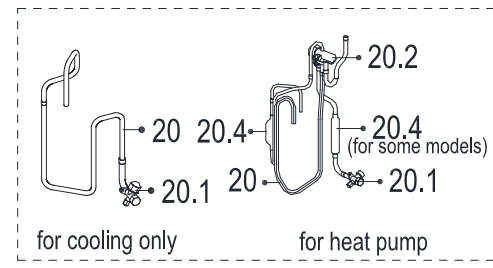
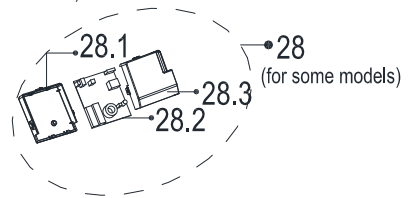
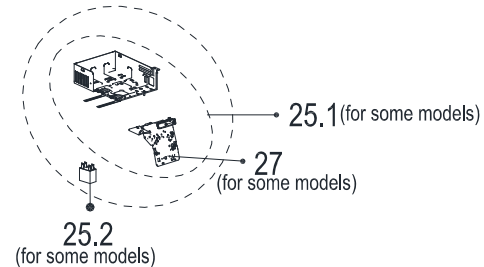
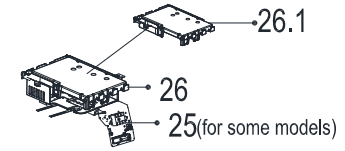
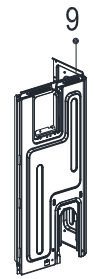
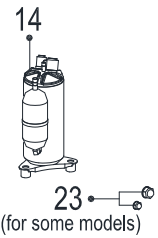
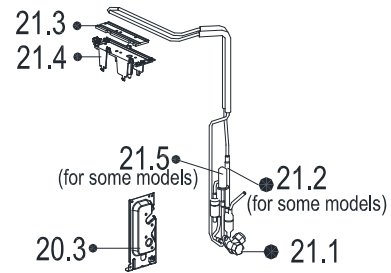
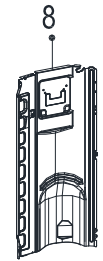
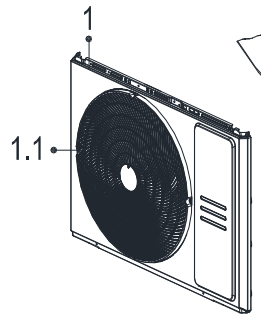
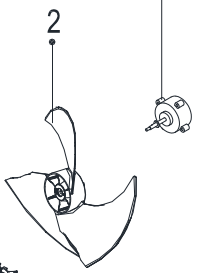
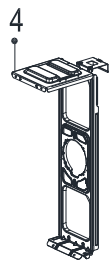
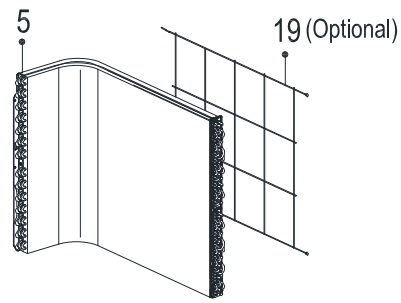
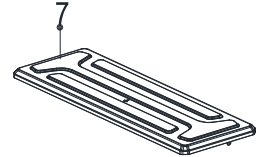

# Optional function parts

- 39
- 40
- 41
- 42
- 43
- 98
- 99

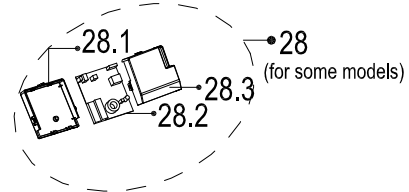
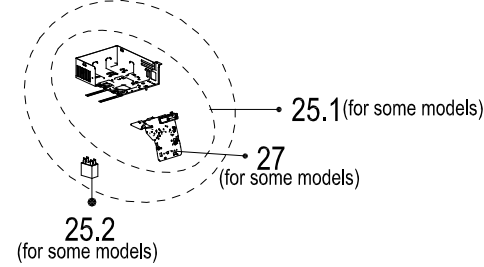
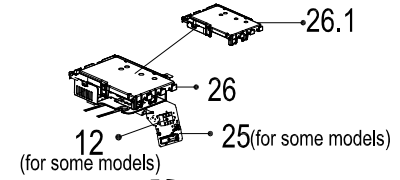
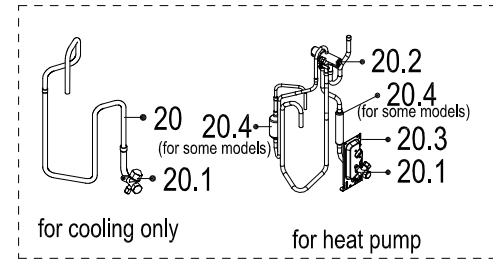
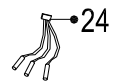
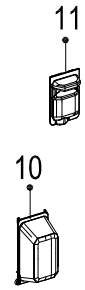
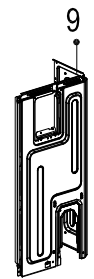
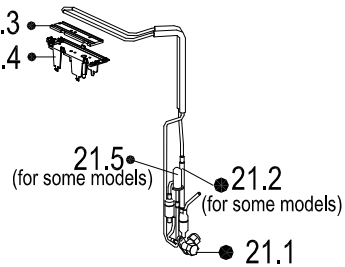
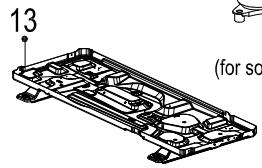
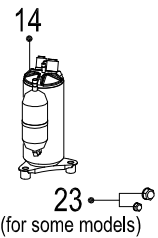
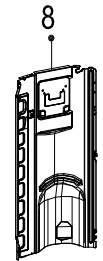
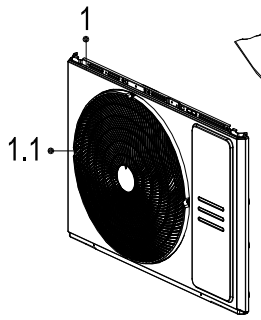
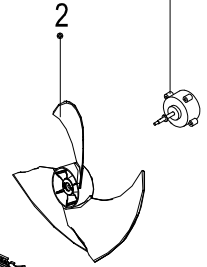
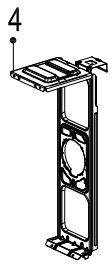
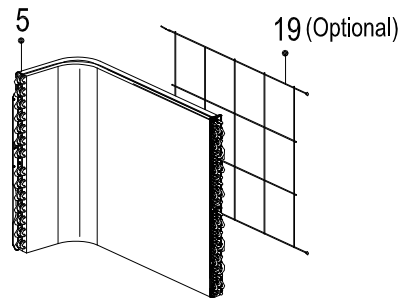
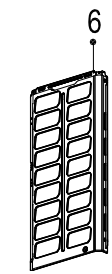
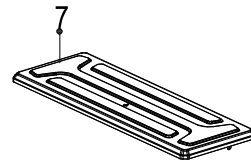

# Optional function parts



39

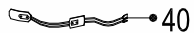

40



41



42



43



98



99

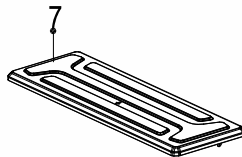

7



6

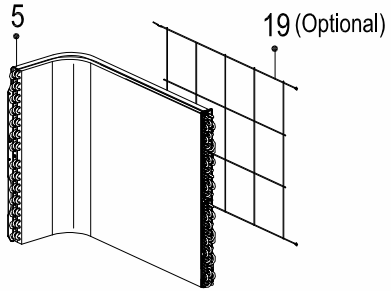

5

19 (Optional)

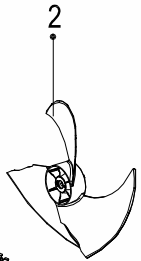

2



3

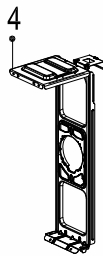

4

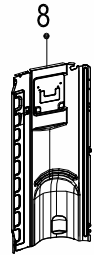

8

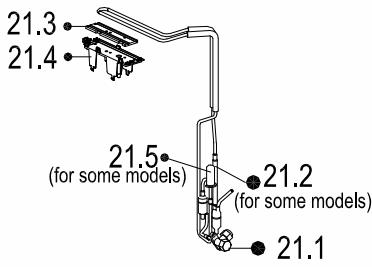

21.3

21.4

21.5 (for some models)

21.2 (for some models)

21.1



14

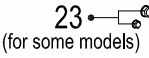

23 (for some models)



9

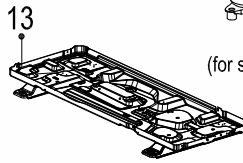

13

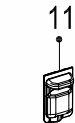

11



10

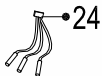

24

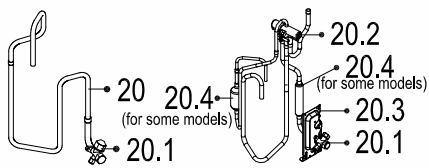
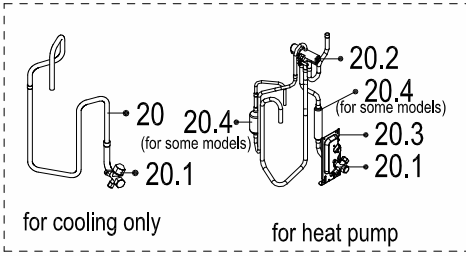

for cooling only

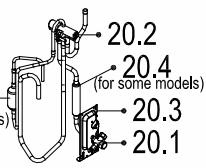

for heat pump

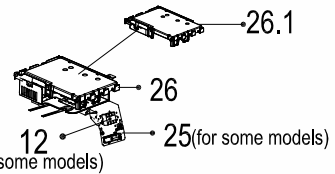

12 (for some models)

26

26.1

25 (for some models)

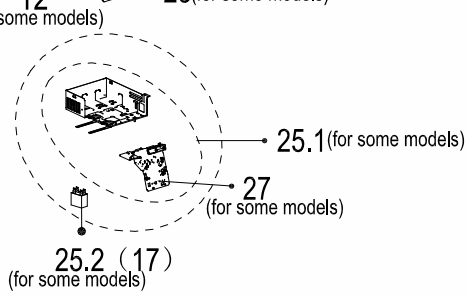

12 (for some models)

25.1 (for some models)

27 (for some models)

25.2 (17) (for some models)

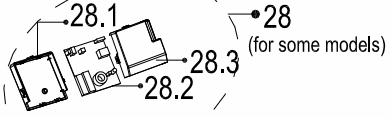

28.1

28.3

28.2

28 (for some models)

Optional function parts

- 39
- 40
- 41
- 42
- 43
- 98
- 99

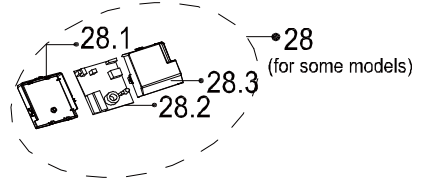
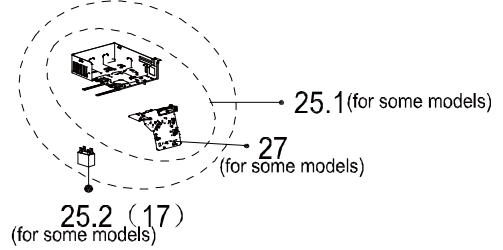
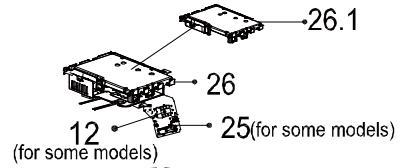
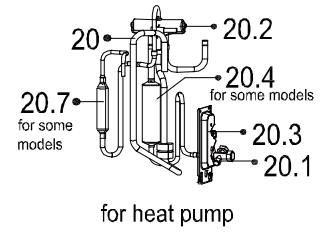
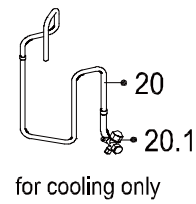
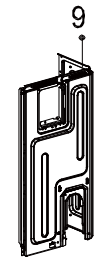
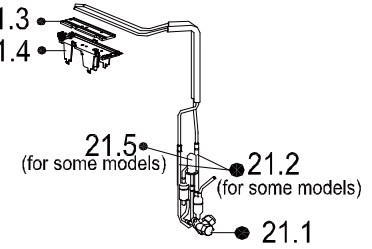
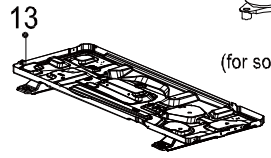
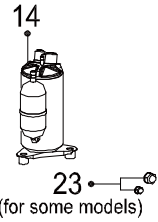
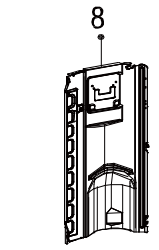
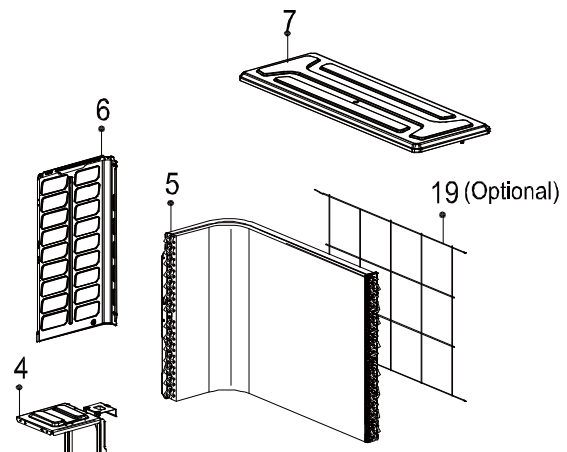
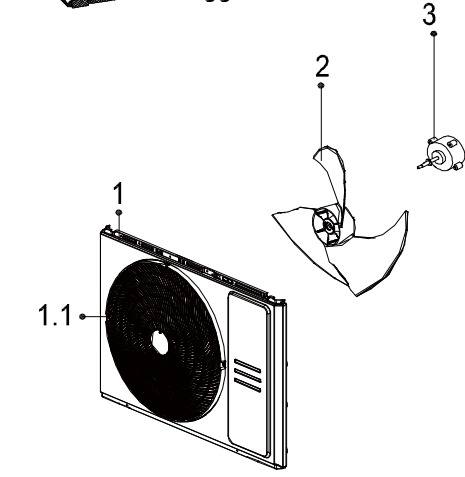

Optional function parts

- 39
- 40
- 41
- 42
- 43
- 98
- 99

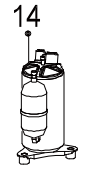
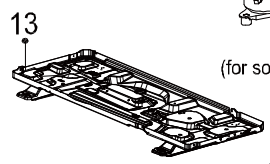
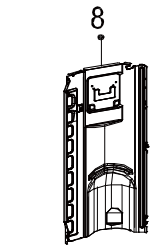
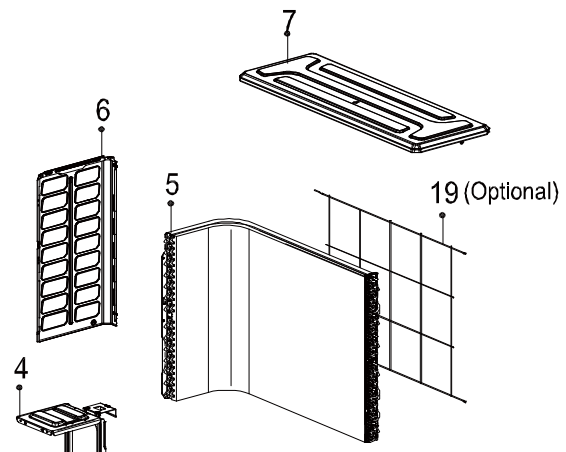
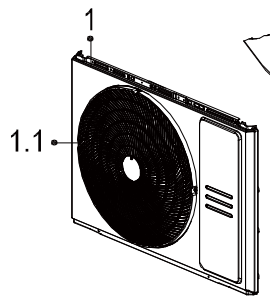
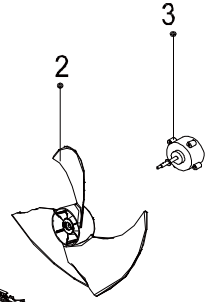

23 (for some models)

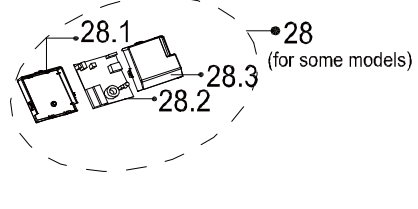
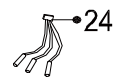
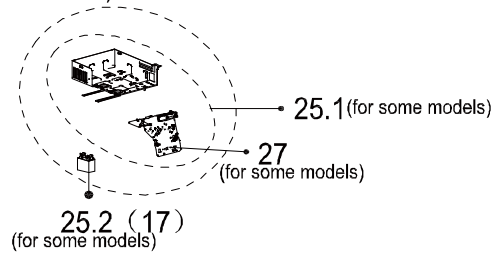
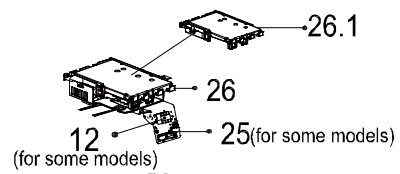
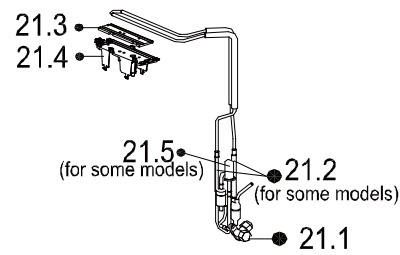
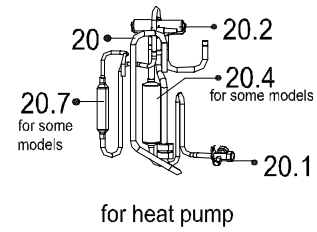
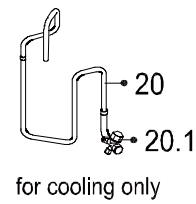
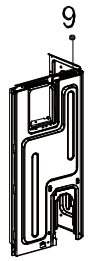

### Exploded View

产品编码(Product model) :

22022016015882

客户编码(Customer No) :

G0000340

客户型号(Customer model) :

MOX430-24HFN8-QRD0GW

订单编码(Order Product Code) :

62220-H6462306

EX_ID	Spare Parts Code	Part Name(CN)	Part Name(EN)	Qty.	Remark2	Part Status	Drawing No	MIN_ORDE R_QTY	Long Term Material(Y or N)	High Rate of Replacemen t(Y or N)	SB Type	Replace Type	Remarks
1	12222000013248	前面板部件	Front panel	1		In Use	KFR-72W-X401.6A	1					
1.1	12122000026481	出风网罩	Air outlet grille	1		In Use	WX401.SL.1	1					
2	12100105000841	轴流风叶	Axial flow fan	1		In Use	ZL-535*133*12-3KFN	1					
3	11002015000366	无刷直流电机	Brushless DC Motor	1		In Use	ZKFN-80-8-3	0					
4	12222000016865	电机支架组件	Supporter subassembly of fan motor	1		In Use	KFR-72W-X401.3B	1					
5	15822000009796	冷凝器部件	Condenser assembly	1		In Use	KFR-72W/BP3N8-X401.JC.ZL.1	1					
6	12222000012929	左侧板	Left supporter	1		In Use	KFR-72W-X401.4-1A	1					
7	12222200005737	顶盖部件	Top cover assembly	1		In Use	KFR-72W-X401.7	1					
8	12222000012366	隔板	Partition board	1		In Use	KFR-72W-X401.2-1	1					
9	12222000012930	右侧板部件	Right clapboard assembly	1		In Use	KFR-72W-X401.5A	1					
10	12122000007150	接水盖	Water collector	1		In Use	BA01.SL.2	1					
11	12122000031166	大把手部件	Big handle assembly	1		In Use	WX201.SL.1	1					
12	17400401000016	接线座(6位)	Terminal	1		In Use	JXZ-PG6H-A	1					
13	12222000013507	底座部件	Chassis Assembly	1		In Use	WX401.BJ.1B	1					
14	11103020006879	变频旋转式压缩机	DC Inverter Rotary Compressor	1		In Use	KTM240D43UKT	1					
19	12222000013085	后网	Rear net	1		In Use	WX401.TS-1	1					
20	15422000018832	四通阀部件	4-way valve assembly	1		In Use	EU-KFR70W/BP3N8-X401(RD0).ZL.1	1					
20.1	15500204000502	低压阀	Gas valve	1		In Use	DYF-C16N2	1					
20.2	15500216000026	四通阀(R410A,线长450,VHR 连接器)	4-way Valve	1		In Use	STF-02BN1(VHR)	1					
20.3	12222200005738	阀安装板	Valve plate	1		In Use	KFR-72W-X401-1	1					
20.4	15122000027161	消声器组件	Muffler subassembly	1		In Use	EU-KFR70W/BP3N8-X401(RD0).ZL.1.1(GT)	1					
20.7	15122000027116	消声器组件	Muffler subassembly	1		In Use	KFR-72W/BP3N8-X401.JC.ZL.2.1A(GT)	1					
21	15422000018833	高压阀部件	Liquid valve Assembly	1		In Use	EU-KFR70W/BP3N8-X401(RD0).ZL.2	1					
21.1	15500208000286	高压阀	Liquid valve	1		In Use	GYF-C27N	1					
21.2	15500210003309	节流阀	Throttle valve	1		In Use	JLF(G)-044-W5.5-N6	1					
21.3	11203803001176	散热器	Radiator	1		In Use	SRQ155.2*37.9*5.3-AIQ80g-N	1					
21.4	12122000011478	U型铜管支撑	U-Typed Support with Copper Pipe	1		In Use	C01.DKH.SL-1	1					
21.5	15500213000176	电子膨胀阀	Electronic expansion valve body	1		In Use	DPF(T01)1.65C-35(L=900)	1					
23	15500406000003	铜螺母	Copper nut	1	A01=6.3 5mm(1/4 in);B02= 9.52mm( 3/8in);C 03=12.7 mm(1/2 in);D04= 15.9mm( 5/8in);E0 5=19mm (3/4in);F 07=22m m(7/8in)	In Use	TLM-D04	0	N	N			
23	15500406000010	铜螺母	Copper nut	1	A01=6.3 5mm(1/4 in);B02= 9.52mm( 3/8in);C 03=12.7 mm(1/2 in);D04= 15.9mm( 5/8in);E0 5=19mm (3/4in);F 07=22m m(7/8in)	In Use	TLM-B02	0	N	N			
24	11201011000188	组合传感器	Combination sensor	1		In Use	CGQ-ZH-GW/SW/PQ-L1100-XH-P900-3(CH)	1					
25	17222000031763	电控盒端子板组件	Terminal board subassembly	1		In Use	KFR-72W/BP3N8-X401.JD.TY.BDZ.DZ1.2-1B	1					
26	17222000033136	外销变频室外电控盒组件	Electronic control box subassembly	1		In Use	EU-KFR70W/BP3N8-X401(LMG+PD22019G23+KTM240+RX24Tmini+6MBP30XSFO60+6892).JD.FW.WXWKB.DK1(AGWL)	1					
26.1	12122000008999	电控安装盒	Electronic installing box	1		In Use	KFR-26W/BP2N1-J181.D.13.DK1.1.1-1A	1					

99	17401203012697	压缩机连接线组	Compressor wire subassembly	1		in Use	PXQ-YSJ200RD/190BL/210BK-14#PA66	1					
----	----------------	---------	-----------------------------	---	--	--------	----------------------------------	---	--	--	--	--	--