

Spare Part List & Exploded View

Liste des Pièces détachées et Vues éclatées

WPSN-127C21.FT3

R290



Updated on: 04 MAY 21

Exploded View - Vues éclatées WPSN-127C21.FT3

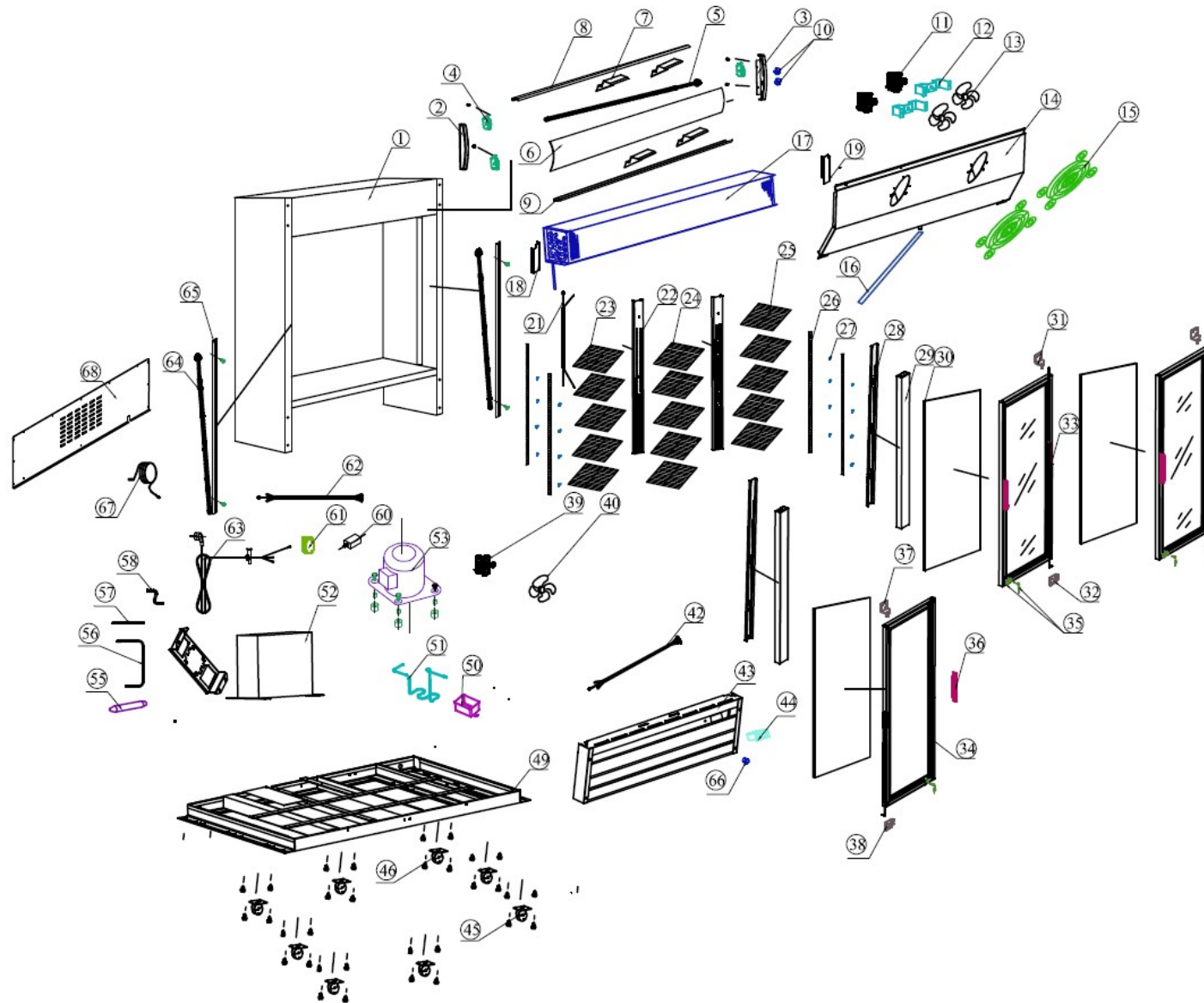

Photos non contractuelles

WPSN-127C21.FT3

Spare parts list

Liste des pièces détachées

N°	Part Name	Part Code	Qty	Qty to order
1	Cabinet	CC.05SS.001		
2	Canopy Side Cover-Left	DZ.709.001.1000WBA(L)-1HG		
3	Canopy Side Cover-Right	DZ.709.002.1000WBA(R)-1AHG		
4	Light Supportor	DZ.708.006.660WA-002-PC		
5	Canopy Led Light	M.305.004.1500-2835-30-01-B-EL		
6	Canopy Cover	P.203A.1500WA-000		
7	Supportor Rail	T.403.008.1000WBA-001		
8	Canopy Up Rail	DZ.40A.001.1500WA-1705-H		
9	Canopy Low Rail	DZ.40A.002.1500WA-1705-H		
10	Light Swtich	M.302.1000WBA-001		
11	Ecm Motor	M.200.001.ECM-PM7112AAA2-03/2		
12	Evap Motor Supportor	DZ.708.006.1000WBA-001-B		
13	Fan Blade	DZ.708.010.660WA-002-B		
14	Evap Cover Assembly	E.203.002.1500WA-003-B		
15	Fan Motor Cover	DZ.708.010.506WA-001		
16	Hose Pipe For Evap	T.211.003.1000WBA-1450		
17	Evaporator	N.15B.002.1500WA-012		
18	Patch Plate For Left	E.300.005.688WA-001		
19	Patch Plate For Right	E.300.005.688WA-002		
20	/			
21	Muffler Pipe	N.300.001.1500WA-010		
22	Back Pole Assembly	E.300.002.1000WBA-014-B		
23	Shelf-Left	P.107.001.1000WBA-001-L		
24	Shelf-Middle	P.107.001.1500WA-003M-B		
25	Shelf-Right	P.107.001.1000WBA-001-R		
26	K-Supportor	T.202.001B.1000WBA-1158		
27	K-Clip	T.204.002.1000WBA-007		
28	Middle Patch Plate	E.103.003.1500WA-005-B		
29	Middle Pole	C.03.001X.1500WA-001A-B		
30	Door Gasket	DM.60H.1500WA-001-H		
31	Up Hinged-Right	T.402.003.1000WBA-002		
32	Low Higned-Right	T.402.003.1000WBA-004		
33	Glass Door-Right	C.02.004.1500WA-01AR-H		
34	Glass Door-Left	C.02.004.1500WA-01AL-H		
35	Lock And Keys	T.402.001.1000WBA-001		
36	Handle	DM.706.001.660WA-001-H		
37	Up Hinged-Left	T.402.003.1000WBA-001		
38	Low Higned-Left	T.402.003.1000WBA-003		
39	Condensor	M.200.001.1000WBA-009/2		
40	Fan Blade	DZ.708.010.660WA-002-B		
41	/			
42	Wires For Controller	M.5L1.002.1000WBA-051		
43	Front Grill	E.207.012.1500WA-008-HGS		
44	Digital Controller	M.401.002.ECS-180(A)		
45	Castor With Brake	T.207.017-B		
46	Castor Without Brake	T.207.011-B		
47	/			
48	/			
49	Bottom Iron Shelf	E.205.001.1500WA-015-B		
50	Water Tray	DZ.708.003.660WA-001		
51	Venting Tube	N.300.002.1500WA-009		
52	Condensor	N.20C.1500WA-001		
53	Compressor	M.10I.KK650CU		
54	/			
55	Direr Filter	N.101.D850WA-001		
56	Connect Tubing Of Condensor	N.300.004.1500WA-005		
57	Connect Tubing Of Compressor	N.300.40A-005		

Specifications are subject to possible modifications without prior notice. Les présentes spécifications sont susceptibles d'être modifiées sans préavis. Las especificaciones están sujetas a cambios sin previo aviso

58	Evaporator Pipe Connecting	N.300.004.1000WBA-017		
59	/			
60	Led Power Source	M.405.001.HS-EVS-A120300P-A0E		
61	Connecting Wires Box	DZ.708.005.660WA-002/1		
62	Wire Of Connecting Compressor	M.5L2.001.360FA-009		
63	Power Plug	M.600.C2-100-2500-H		
64	Inner Led Light	M.305.004.1200-2835-30-01-B-EL		
65	Inner Light Cover	DZ.501.003.338FA-1358		
66	Power Swtich	M.302.1000WBA-001		
67	Probe	M.401.002.1000WBA-008-3500		
68	Rear Cover	E.208.001.1500WA-011		